



quick start guide

Depletion Wand

Safety Precautions

THANK YOU FOR YOUR INTEREST IN OUR PRODUCTS

Please use this equipment carefully and observe all warnings and cautions.



WARNING!

Please read precautions thoroughly before operation. Meet all applicable local codes and regulations.

WEAR

Protective clothing and eye wear when dispensing chemicals or other materials or when working in the vicinity of all chemicals, filling or emptying equipment, or changing metering tips.

ALWAYS

Observe safety and handling instructions of the chemical manufacturer. Direct discharge away from you or other persons or into approved containers. Dispense cleaners and chemicals in accordance with manufacturer's instructions. Exercise CAUTION when maintaining your equipment. Reassemble equipment according to instruction procedures. Be sure all components are firmly screwed or latched into position.

KEEP

Equipment clean to maintain proper operation.

design variations

38mm design

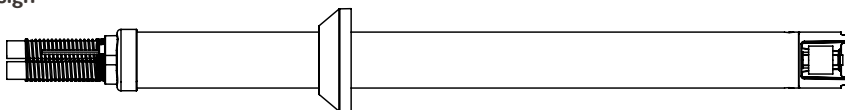

48mm design

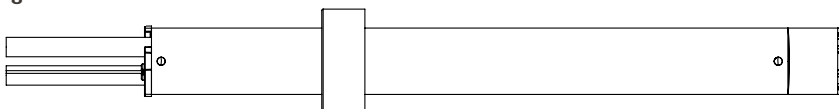

fitting optional mesh filter - 38mm models

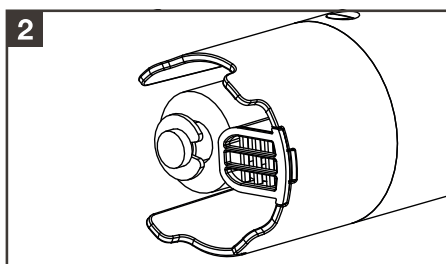
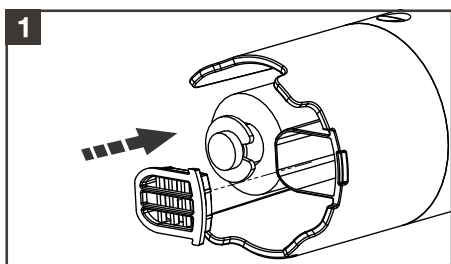

chemical drum assembly

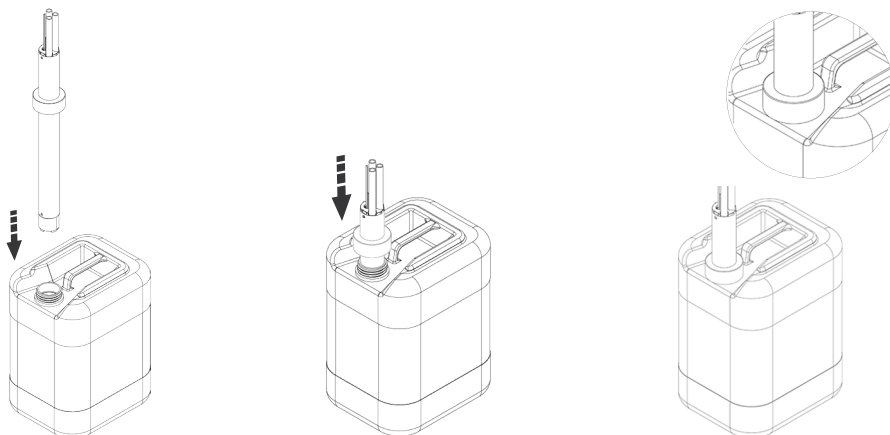

connecting to the Low Level Alarm

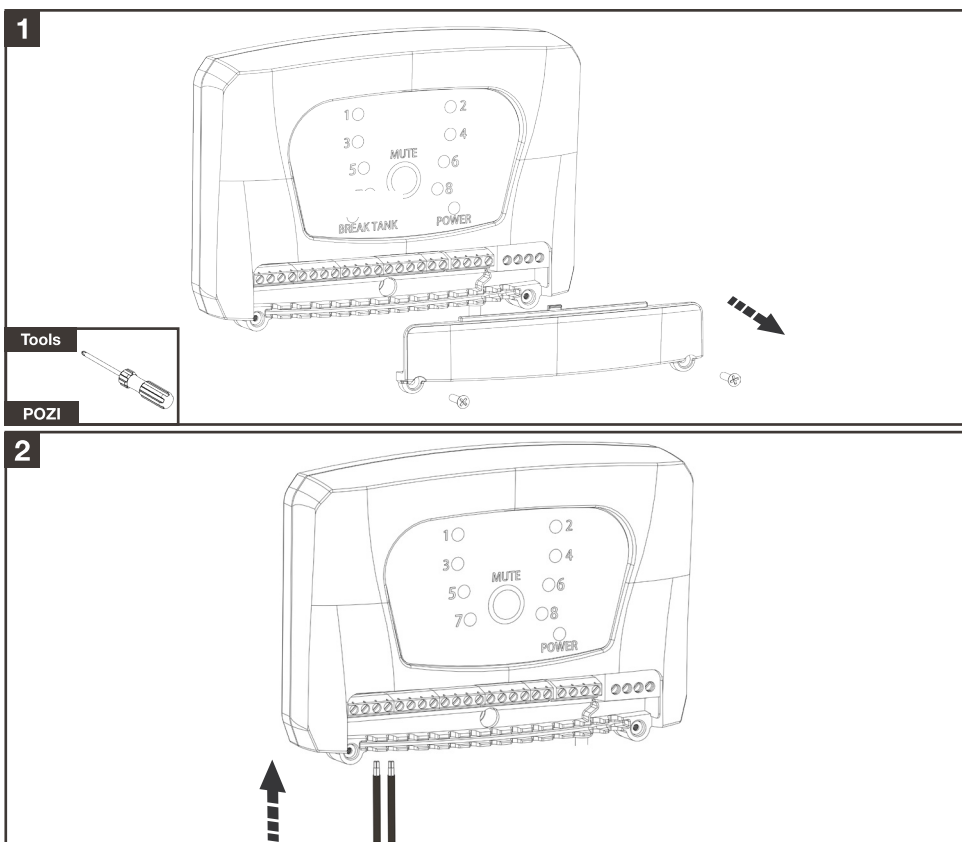

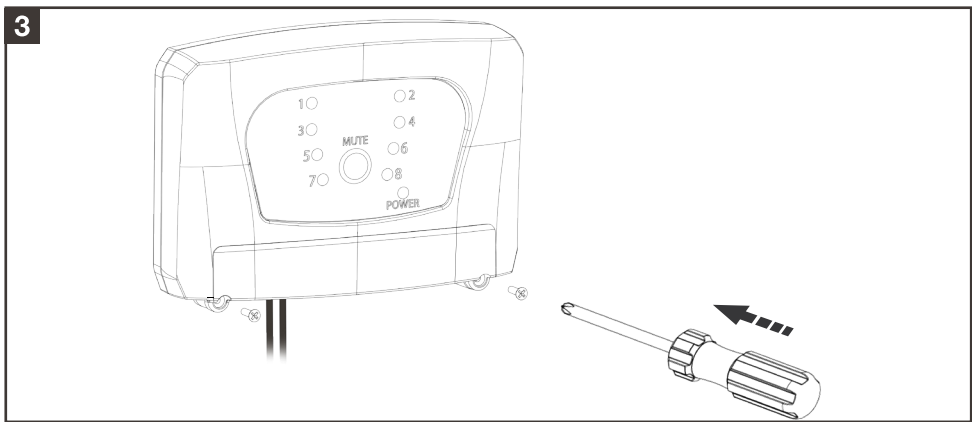

connecting to the EvoClean

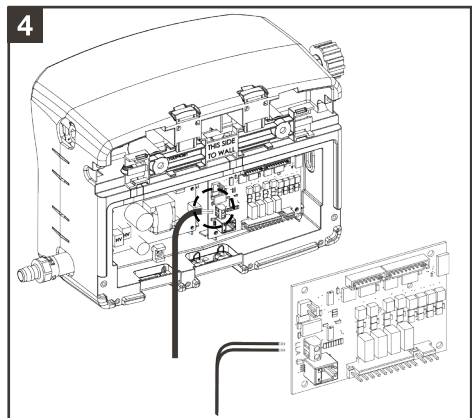
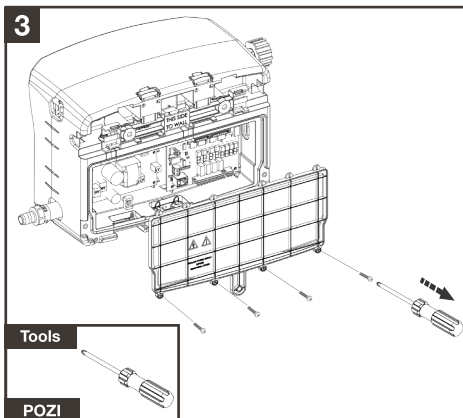
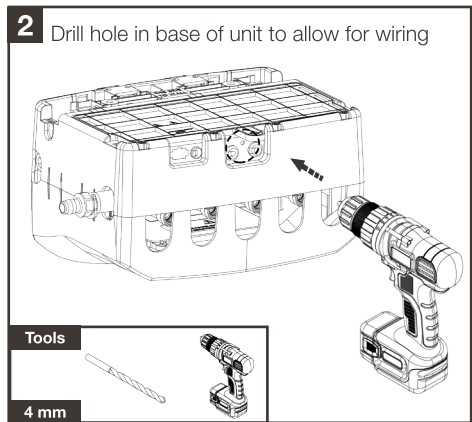
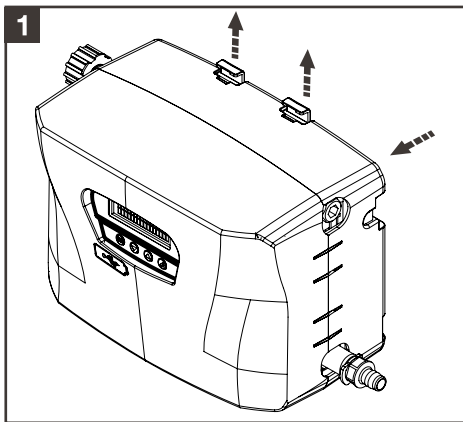

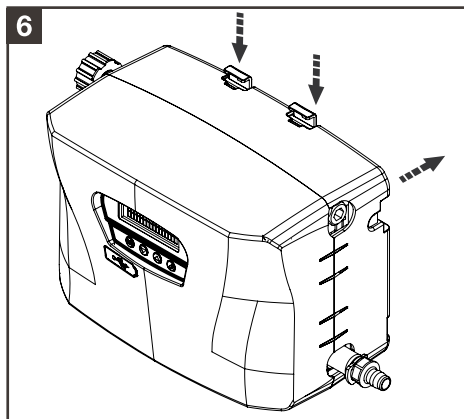
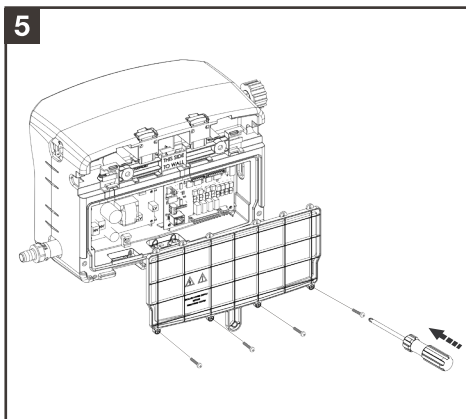

To connect multiple depletion wands, to the Evoclean unit, follow the same instructions, adding additional units in parallel.

warranty

Limited Warranty

Seller warrants solely to **Buyer** the Products will be free from defects in material and workmanship under normal use and service for a period of one year from the date of completion of manufacture. This limited warranty does not apply to (a) hoses; (b) and products that have a normal life shorter than one year; or (c) failure in performance or damage caused by chemicals, abrasive materials, corrosion, lightning, improper voltage supply, physical abuse, mishandling or misapplication. In the event the Products are altered or repaired by **Buyer** without **Seller's** prior written approval, all warranties will be void.

No other warranty, oral, express or implied, including any warranty of merchantability or fitness for any particular purpose, is made for these products, and all other warranties are hereby expressly excluded.

Seller's sole obligation under this warranty will be, at **Seller's** option, to repair or replace F.O.B. **Seller's** facility in Cincinnati, Ohio or Bracknell, England any Products found to be other than as warranted.

Limitation of Liability

Seller's warranty obligations and **Buyer's** remedies are solely and exclusively as stated herein. **Seller** shall have no other liability, direct or indirect, of any kind, including liability for special, incidental, or consequential damages or for any other claims for damage or loss resulting from any cause whatsoever, whether based on negligence, strict liability, breach of contract or breach of warranty.

Support Files and Additional Information

This quick start guide should be used if you are already familiar with installing and using dispensing systems. A more detailed user manual and additional information can be found on our website. Please visit www.hydrosystemsco.com/product/depletion-wand for the complete user manual.



Hydro Systems
3798 Round Bottom Road,
Cincinnati, OH 45244

Phone 513.271.8800
Toll Free 800.543.7184
Fax 513.271.0160
Web hydrosystemsco.com

HYD 10099679
Rev 4 09/2020